

for short-stroke cylinders
Magnetic cylinder sensor

- Simple mounting on short-stroke cylinders
- High repeat accuracy
- Solid aluminium housing with special profile and clamping screw
- Cable or connector
- LED status indicator

Dimensional drawing

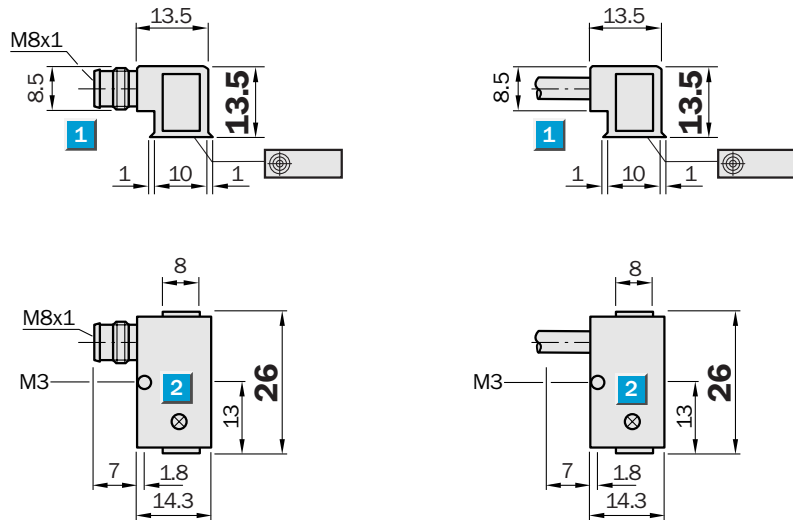

- 1 Connection
- 2 Display LED



Connection type

MZK1-02VPS-ATO

MZK1-02VPS-AU0

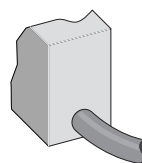
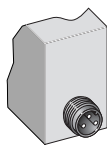

M8, 3-pin

3 x 0.25 mm²

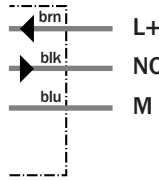
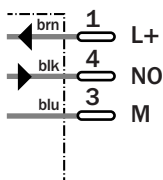

See chapter Accessories

Connector, M8, 3-pin

| Technical specifications | | MZK1- | 02VPS -ATO | 02VPS -AU0 | | | | | | | | | |
|--|--|-------|---------------|---------------|--|--|--|--|--|--|--|--|--|
| Sensing face | Front | | | | | | | | | | | | |
| Electrical configuration | DC 3-wire | | | | | | | | | | | | |
| Supply voltage V_s | DC 10 ... 30 V | | | | | | | | | | | | |
| Response sensitivity | 2 mT | | | | | | | | | | | | |
| Ripple U_{pp} | $\leq 10\%$ ¹⁾ | | | | | | | | | | | | |
| Voltage drop U_d | $\leq 1.5\text{ V}$ ²⁾ | | | | | | | | | | | | |
| Power consumption | $\leq 10\text{ mA}$ ³⁾ | | | | | | | | | | | | |
| Continuous current I_a | $\leq 300\text{ mA}$ | | | | | | | | | | | | |
| Time delay before availability t_v | $\leq 2\text{ ms}$ | | | | | | | | | | | | |
| Hysteresis H, of s_r | $\leq 1\text{ mm}$ | | | | | | | | | | | | |
| Repeatability R | $\leq 0.1\text{ mm}$ (U_b and T_a constant) | | | | | | | | | | | | |
| EMC | According to EN 60947-5-2 | | | | | | | | | | | | |
| Switching output | PNP | | | | | | | | | | | | |
| Output function | Normally open | | | | | | | | | | | | |
| Connection type | Connector, M8, 3-pin | | | | | | | | | | | | |
| | Cable, PVC/PUR, 2 m | | | | | | | | | | | | |
| Enclosure rating | IP 67 ⁴⁾ | | | | | | | | | | | | |
| Max. switching frequency | 5,000 Hz | | | | | | | | | | | | |
| Wire-break protection | ✓ | | | | | | | | | | | | |
| Short-circuit protection | ✓ ⁵⁾ | | | | | | | | | | | | |
| Reverse polarity protection | ✓ | | | | | | | | | | | | |
| Power-up pulse suppression | ✓ | | | | | | | | | | | | |
| Shock/vibration stress | 30 g, 11 ms/10 ... 55 Hz, 1 mm | | | | | | | | | | | | |
| Ambient temperature T_a | -25 °C ... +75 °C | | | | | | | | | | | | |
| Housing material | Aluminium, plastic | | | | | | | | | | | | |

¹⁾ of U_b

²⁾ at I_a max

³⁾ without load

⁴⁾ according to EN 60529
⁵⁾ (pulsed)

Ordering information

| Type | Order no. |
|----------------|-----------|
| MZK1-02VPS-ATO | 7 900 604 |
| MZK1-02VPS-AU0 | 7 900 602 |