



HW1980IFR-3SER KIT

HW19

MOBILE HANDHELD SCANNERS

SICK
Sensor Intelligence.



Ordering information

Type	Part no.
HW1980IFR-3SER KIT	6059466

Included in delivery: Connection cable (male connector-female connector) (1), HW1980IFR-3 (1)

A country-specific power supply unit may be required for operation (see "Recommended accessories").

Other models and accessories → www.sick.com/HW19



Detailed technical data

Features

Task	Identifying - 1D code Identifying - 2D code
Version	Full Range Focus
Application	Industrial application
Scanner design	Cable connection variant
Sensor resolution	1,280 px x 800 px
Light source	LED, Visible, Red, 624 nm, ± 18 nm
Alignment aid	Laser, Red, 650 nm
Reading distance	150 mm ... 16,000 mm
Code resolution	≥ 0.05 mm ¹⁾ ≥ 2 mm ²⁾

¹⁾ Close range.

²⁾ Distance range.

Mechanics/electronics

Supply voltage	4 V DC ... 5.5 V DC
Current consumption	Operation at 5 V DC: 470 mA Standby: 100 mA
Housing	Plastic (UL 94 V-0)
Housing color	Orange, gray
Enclosure rating	IP65
Weight	335 g
Dimensions (L x W x H)	133 mm x 75 mm x 195 mm

Performance

Readable code structures	1D codes, 2D codes, Stacked
Bar code types	Code 39, Code 39 Trioptic, Code 32, Code 93, Code 11, Codabar, Code 128, GS1-128 / EAN 128, UPC / EAN / JAN (with addition), MSI/Plessey, UK/Plessey, IATA, Interleaved 2 of 5, Standard and Industrial 2 of 5, Matrix 2 of 5, Telepen, GS1 DataBar, Australian Post, China Post,

	German Post, US Planet, US Postnet, British Post, Intelligent Mail, Japan Post, Korean Post, Dutch KIX Post
2D code types	Data Matrix, QR code, MicroQR-Code, Aztec, MaxiCode
Stacked code types	PDF417, MicroPDF417, Code 49, Code 16K, Composite, Codablock F
Code alignment	Omni-directional

Interfaces

Ethernet	✓, TCP/IP
Type of fieldbus integration	Optional over external fieldbus module CDF600-2
PROFINET	✓
Type of fieldbus integration	Optional over external fieldbus module CDF600-2
Function	PROFINET Single Port, PROFINET Dual Port
EtherCAT	✓
Type of fieldbus integration	Optional over external fieldbus module CDF600
Serial	✓, RS-232 TTL
Remark	RS-232 (± 12 V)
PROFIBUS DP	✓
Type of fieldbus integration	Optional over external fieldbus module CDF600-2
Optical indicators	2 LEDs (good read, charge of battery, radio connection status)
Acoustic indicators	Beeper, can be switched off
Vibration	Yes
Configuration software	EZConfig Tool

Ambient data

Shock resistance	50 drop tests onto concrete from a height of 2 m at -30 °C
Ambient operating temperature	-30 °C ... +50 °C
Storage temperature	-40 °C ... +70 °C
Permissible relative humidity	95 %, Non-condensing
Ambient light immunity	100,000 lx
Bar code print contrast (PCS)	≥ 40 %

Classifications

ECLASS 5.0	27280101
ECLASS 5.1.4	27280101
ECLASS 6.0	27280101
ECLASS 6.2	27280101
ECLASS 7.0	27280101
ECLASS 8.0	27280101
ECLASS 8.1	27280101
ECLASS 9.0	27280101
ECLASS 10.0	27280101
ECLASS 11.0	27280101
ECLASS 12.0	27280101
ETIM 5.0	EC002550
ETIM 6.0	EC002550

ETIM 7.0	EC002550
ETIM 8.0	EC002550
UNSPSC 16.0901	43211701

Connection diagram

PROFINET IO/RT

PROFINET IO/RT

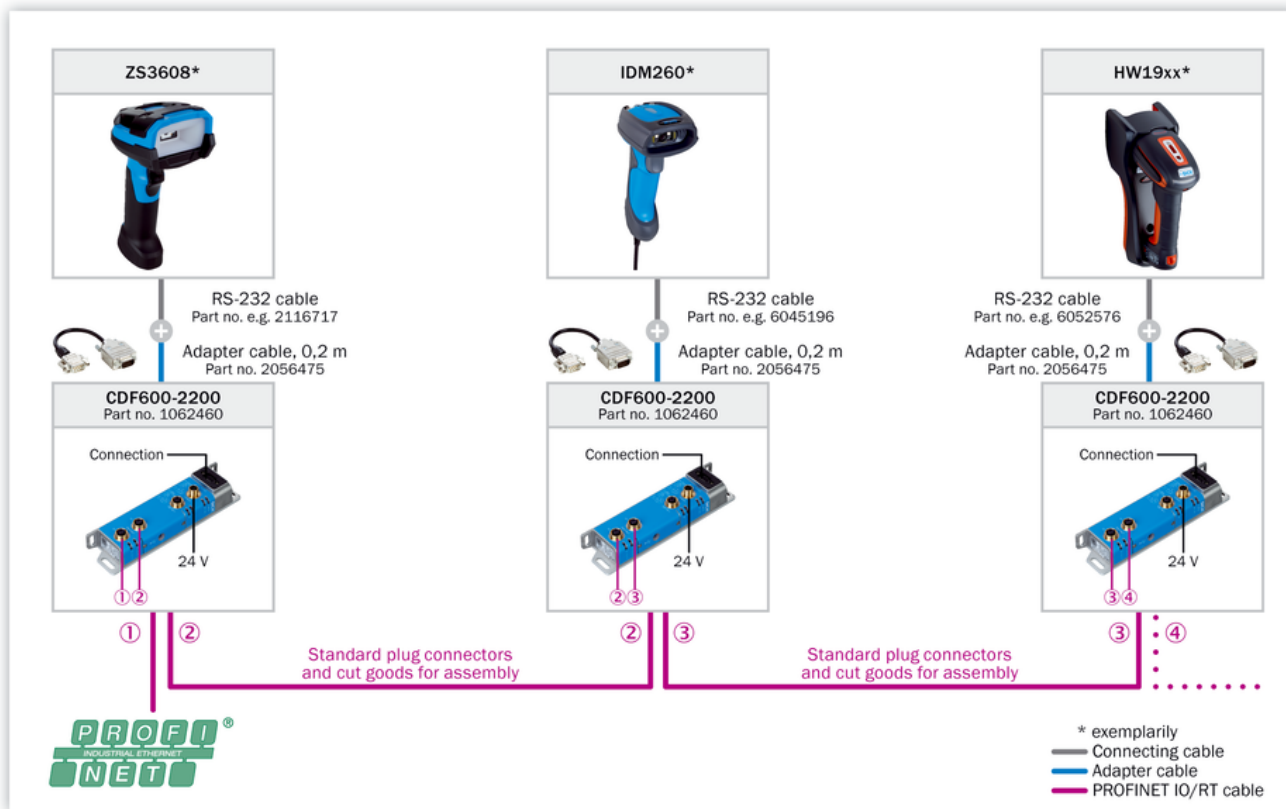

PROFIBUS DP

PROFIBUS DP

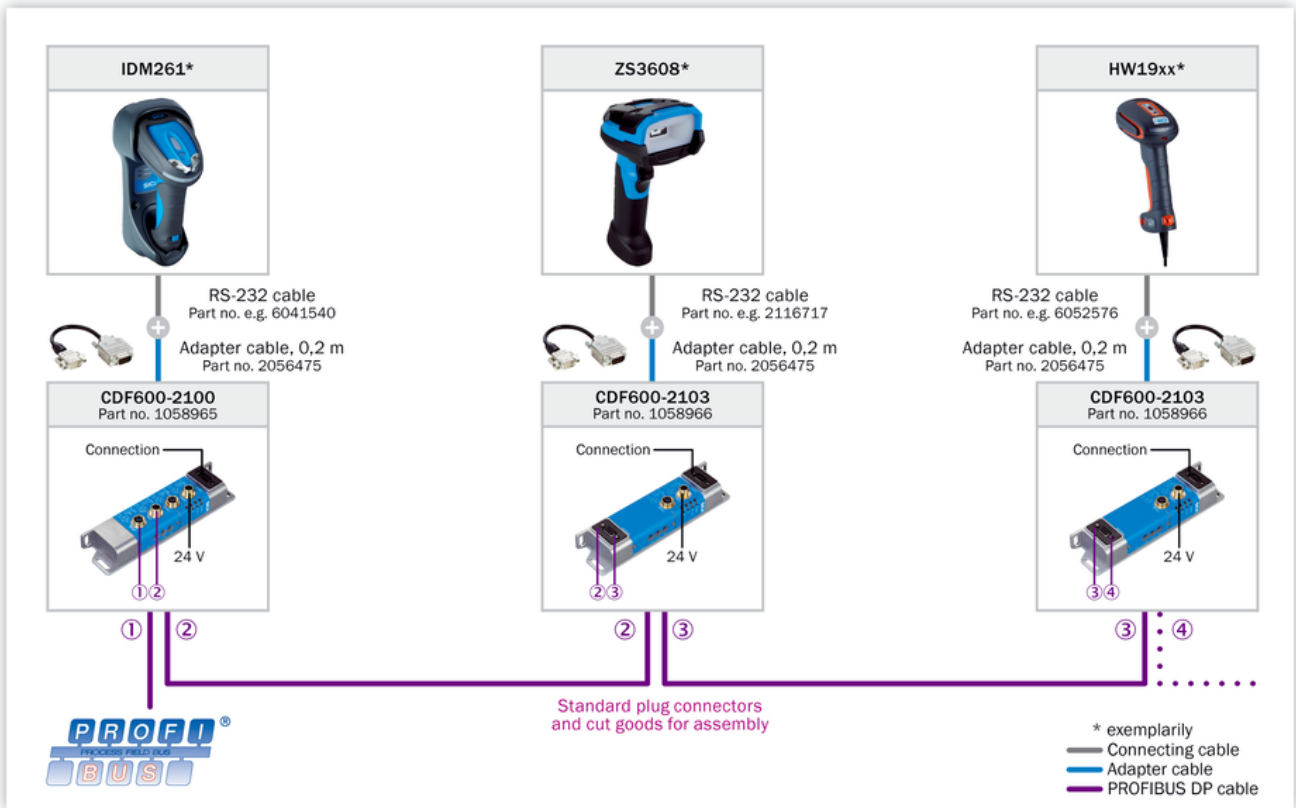

EtherCAT®

EtherCAT®

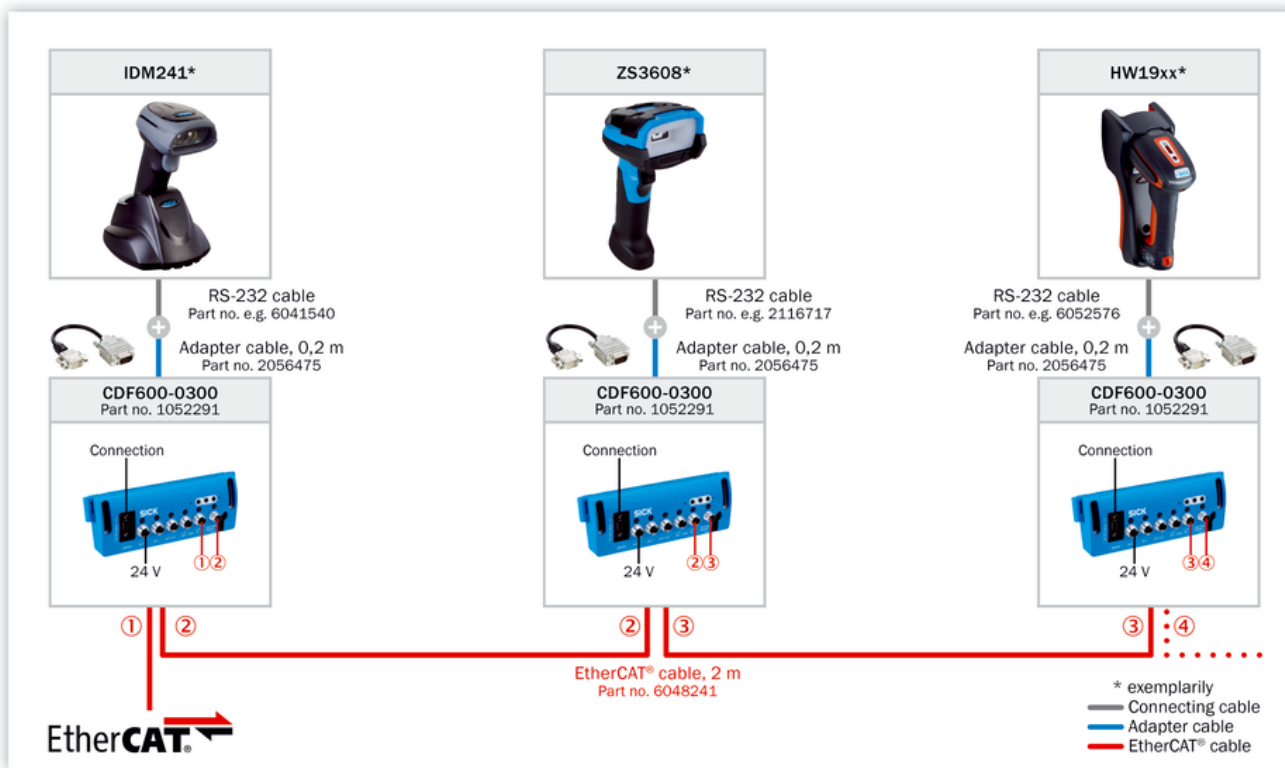

AUX looping

Looping-in via AUX

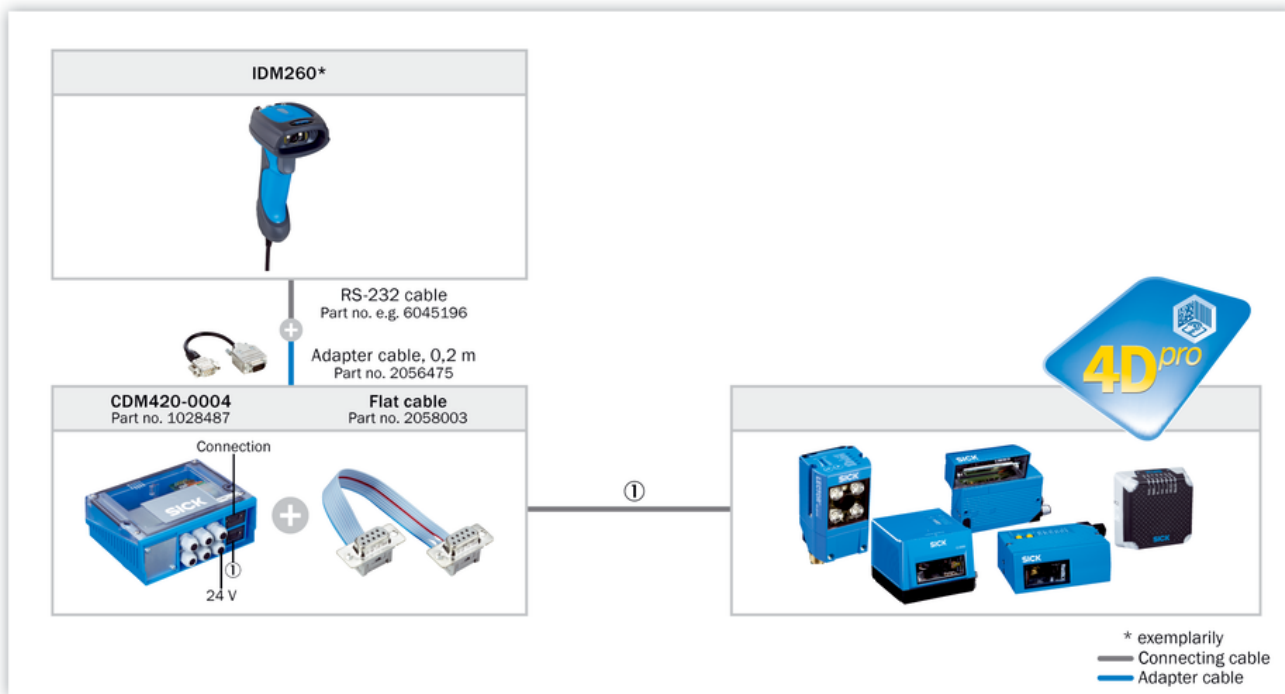

Selection Guide



*) For EtherNet/IP third party gateway is required from e.g. Control or HMS (requires local sourcing).

Recommended accessories

Other models and accessories → www.sick.com/HW19

	Brief description	Type	Part no.
Others			
	<ul style="list-style-type: none"> Connection type head A: Male connector, USB-A Connection type head B: Male connector, RJ45 Signal type: USB Cable: 3 m, coiled cable Description: USB, Keyboard connector or USB Com Port Emulation, 5 V host power (Honeywell CBL-500-300-C00) 	USB cable	6052577
	<ul style="list-style-type: none"> Connection type head A: Female connector, D-Sub, 9-pin, straight Connection type head B: Male connector, RJ45 Signal type: RS-232 TTL Cable: 3 m, coiled cable Description: RS-232 TTL, 5 V external voltage supply with option for host voltage supply on pin 9, industrial grade (Honeywell CBL-020-300-C00-01) 	Connection cable (male connector-female connector)	6064034
	<ul style="list-style-type: none"> Connection type head A: Male connector, USB-A Connection type head B: Male connector, RJ45 Signal type: USB Cable: 3 m, straightened cable Description: USB, Keyboard connector or USB Com Port Emulation, 5 V host power, industrial grade (Honeywell CBL-500-300-S00-01) 	USB cable	6064633

SICK AT A GLANCE

SICK is one of the leading manufacturers of intelligent sensors and sensor solutions for industrial applications. A unique range of products and services creates the perfect basis for controlling processes securely and efficiently, protecting individuals from accidents and preventing damage to the environment.

We have extensive experience in a wide range of industries and understand their processes and requirements. With intelligent sensors, we can deliver exactly what our customers need. In application centers in Europe, Asia and North America, system solutions are tested and optimized in accordance with customer specifications. All this makes us a reliable supplier and development partner.

Comprehensive services complete our offering: SICK LifeTime Services provide support throughout the machine life cycle and ensure safety and productivity.

For us, that is “Sensor Intelligence.”

WORLDWIDE PRESENCE:

Contacts and other locations –www.sick.com