



Y8A36A2-LXXXUBA050

Passive distribution boxes

PLUG CONNECTORS AND CABLES

SICK
Sensor Intelligence.



Ordering information

| Type | Part no. |
|--------------------|----------|
| Y8A36A2-LXXXUBA050 | 2115728 |

Other models and accessories → www.sick.com/Passive_distribution_boxes



Detailed technical data

Technical specifications

| | |
|----------------------------------|---|
| Shielding | Unshielded |
| Number of slots | 6 |
| Slot connection type | M8, 3-pin, A-coded, female connector |
| Root port connection type | Flying leads |
| Connecting cable | 5 m, 8-wire, PUR, halogen-free |
| Cable diameter | 8.5 mm |
| Cable color | Gray |
| Conductor cross section | 2 x 0.75 mm ² + 6 x 0.34 mm ² |
| Traversing speed | 2 m/s |
| Travelling distance | 5 m |
| Acceleration | ≤ 5 m/s ² |
| Bending radius | |
| Flexible use | > 10 x cable diameter |
| Stationary position | > 10 x cable diameter |
| Drag chain operation | > 10 x cable diameter |
| Bending cycles | ≤ 5,000,000 |
| Tightening torque | |
| Slots | 0.4 Nm |
| Display LED | |
| Slots | 1 x per socket |
| Root port | 1x per distributor |
| Reference voltage | ≤ 24 V DC |
| Current loading | 10 A |
| Overtoltage category | III |
| Operating temperature | |
| Flexible use | -5 °C ... +80 °C |
| Stationary position | -40 °C ... +80 °C |
| Drag chain operation | -5 °C ... +60 °C |

| | |
|-------------------------|---------------------|
| Distributor box | -20 °C ... +72 °C |
| Enclosure rating | IP65/ IP67 |
| UL File No. | E238799 |
| Authorizations | UL CE |
| Items supplied | 5 x labeling plates |

Classifications

| | |
|-----------------------|----------|
| ECLASS 5.0 | 27279201 |
| ECLASS 5.1.4 | 27279201 |
| ECLASS 6.0 | 27279201 |
| ECLASS 6.2 | 27279201 |
| ECLASS 7.0 | 27279201 |
| ECLASS 8.0 | 27279201 |
| ECLASS 8.1 | 27279201 |
| ECLASS 9.0 | 27440108 |
| ECLASS 10.0 | 27440108 |
| ECLASS 11.0 | 27440108 |
| ECLASS 12.0 | 27440108 |
| ETIM 5.0 | EC002585 |
| ETIM 6.0 | EC002585 |
| ETIM 7.0 | EC002585 |
| ETIM 8.0 | EC002585 |
| UNSPSC 16.0901 | 31163032 |

Dimensional drawing (Dimensions in mm (inch))

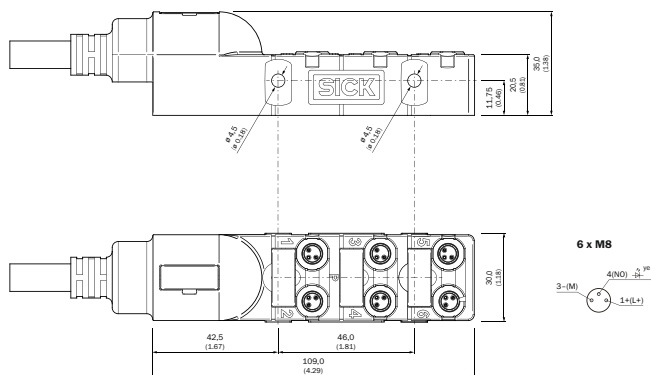

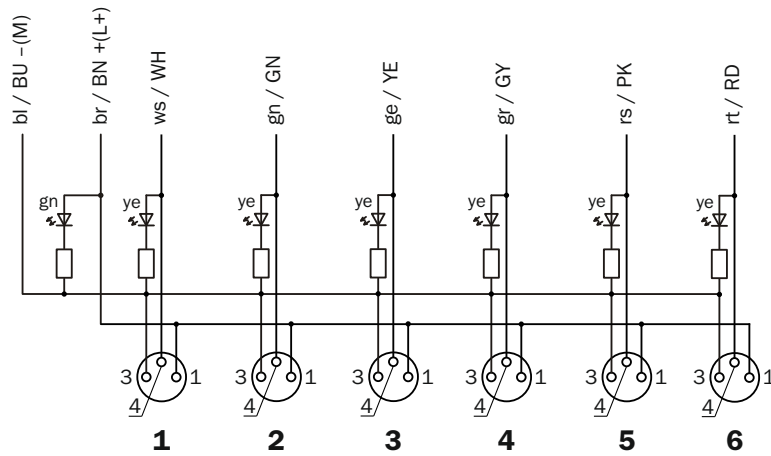

Connection diagram

Cd-475



Recommended accessories

Other models and accessories → www.sick.com/Passive_distribution_boxes

| | Brief description | Type | Part no. |
|---|---|--------------------|----------|
| Device protection (mechanical) | | | |
|  | 1 piece, Protective cap for M8 socket or unused ports | DOS-08SK | 5340762 |
| Others | | | |
|  | <ul style="list-style-type: none"> • Connection type head A: Female connector, M8, 3-pin, straight, A-coded • Connection type head B: Male connector, M8, 3-pin, straight, A-coded • Signal type: Sensor/actuator cable • Cable: 5 m, 3-wire, PUR, halogen-free • Description: Sensor/actuator cable, unshielded • Application: Zones with oils and lubricants, Drag chain operation, Robot | YF8U13-050UA1M8U13 | 2096308 |

SICK AT A GLANCE

SICK is one of the leading manufacturers of intelligent sensors and sensor solutions for industrial applications. A unique range of products and services creates the perfect basis for controlling processes securely and efficiently, protecting individuals from accidents and preventing damage to the environment.

We have extensive experience in a wide range of industries and understand their processes and requirements. With intelligent sensors, we can deliver exactly what our customers need. In application centers in Europe, Asia and North America, system solutions are tested and optimized in accordance with customer specifications. All this makes us a reliable supplier and development partner.

Comprehensive services complete our offering: SICK LifeTime Services provide support throughout the machine life cycle and ensure safety and productivity.

For us, that is “Sensor Intelligence.”

WORLDWIDE PRESENCE:

Contacts and other locations –www.sick.com