



IDM261-311S

IDM

MOBILE HANDHELD SCANNERS

SICK
Sensor Intelligence.



Ordering information

Type	Part no.
IDM261-311S	6068400

Other models and accessories → www.sick.com/IDM



Detailed technical data

Features

Application	Industrial application
Scanner design	Wireless variant
Sensor resolution	1,280 px x 800 px
Light source	LED, Visible, Red, 660 nm
Alignment aid	Laser, Red, 630 nm
Laser class	1 (EN/IEC 60825-1:2014)
Reading distance	30 mm ... 400 mm
Code resolution	≥ 0.07 mm ¹⁾ ≥ 0.13 mm ²⁾

¹⁾ Valid for Code 39.

²⁾ Valid for Data Matrix code.

Mechanics/electronics

Supply voltage	5 V DC, ± 5 %
Current consumption	Operation (charge status incl. base station): 750 mA Standby: 175 mA
Housing color	Blue, gray
Enclosure rating	IP65
Weight	228 g
Dimensions (L x W x H)	104 mm x 76.3 mm x 176 mm
MTBF	100,000 h

Performance

Readable code structures	1D codes, 2D codes, Stacked
Bar code types	Code 39, Code 39 Trioptic, Code 32, Code 93, Code 11, Codabar, Code 128, GS1-128 / EAN 128, UPC / EAN / JAN (with addition), MSI/Plessey, UK/Plessey, IATA, Interleaved 2 of 5, Standard and Industrial 2 of 5, Matrix 2 of 5, Telepen, GS1 DataBar, Australian Post, China Post,

	German Post, US Planet, US Postnet, British Post, Intelligent Mail, Japan Post, Korean Post, Dutch KIX Post
2D code types	Data Matrix, QR code, MicroQR-Code, Aztec, MaxiCode
Stacked code types	PDF417, MicroPDF417, Code 49, Code 16K, Composite, Codablock F
Battery power	Over 60,000 scans with full battery
Code buffer	5,000 Codes (EAN, for scanning in batch mode), 100,000 Codes (EAN, for out of range scanning)

Interfaces

Ethernet	✓, TCP/IP
Type of fieldbus integration	Optional, over external connection module CDF600-2
PROFINET	✓
Type of fieldbus integration	Optional over external fieldbus module CDF600-2
Function	PROFINET Single Port, PROFINET Dual Port
EtherCAT	✓
Type of fieldbus integration	Optional over external fieldbus module CDF600
Serial	✓, RS-232
PROFIBUS DP	✓
Type of fieldbus integration	Optional over external fieldbus module CDF600-2
USB	✓
Function	Keyboard wedge, COM-Port emulation
Bluetooth	✓
Remark	Bluetooth™ V4.0, 2.402 ... 2.4830 GHz
Function	Wireless operating range up to 100 m (free view), batch function for expansion of the wireless radius, up to seven scanners communicate with one base station
Optical indicators	2 LEDs (good read, charge of battery, radio connection status)
Acoustic indicators	Beeper, can be switched off
Vibration	Yes
Configuration software	IDM Setup Tool

Ambient data

Shock resistance	50 drops from 2 m height on concrete
Ambient operating temperature	-20 °C ... +50 °C
Storage temperature	-40 °C ... +70 °C
Permissible relative humidity	95 %, Non-condensing
Ambient light immunity	100,000 lx

General notes

Items supplied	The rechargeable battery is included with delivery
Note	Not free of paint wetting impairment substances.

Classifications

ECLASS 5.0	27280101
ECLASS 5.1.4	27280101
ECLASS 6.0	27280101
ECLASS 6.2	27280101

ECLASS 7.0	27280101
ECLASS 8.0	27280101
ECLASS 8.1	27280101
ECLASS 9.0	27280101
ECLASS 10.0	27280101
ECLASS 11.0	27280101
ECLASS 12.0	27280101
ETIM 5.0	EC002550
ETIM 6.0	EC002550
ETIM 7.0	EC002550
ETIM 8.0	EC002550
UNSPSC 16.0901	43211701

Connection diagram

PROFINET IO/RT

PROFINET IO/RT

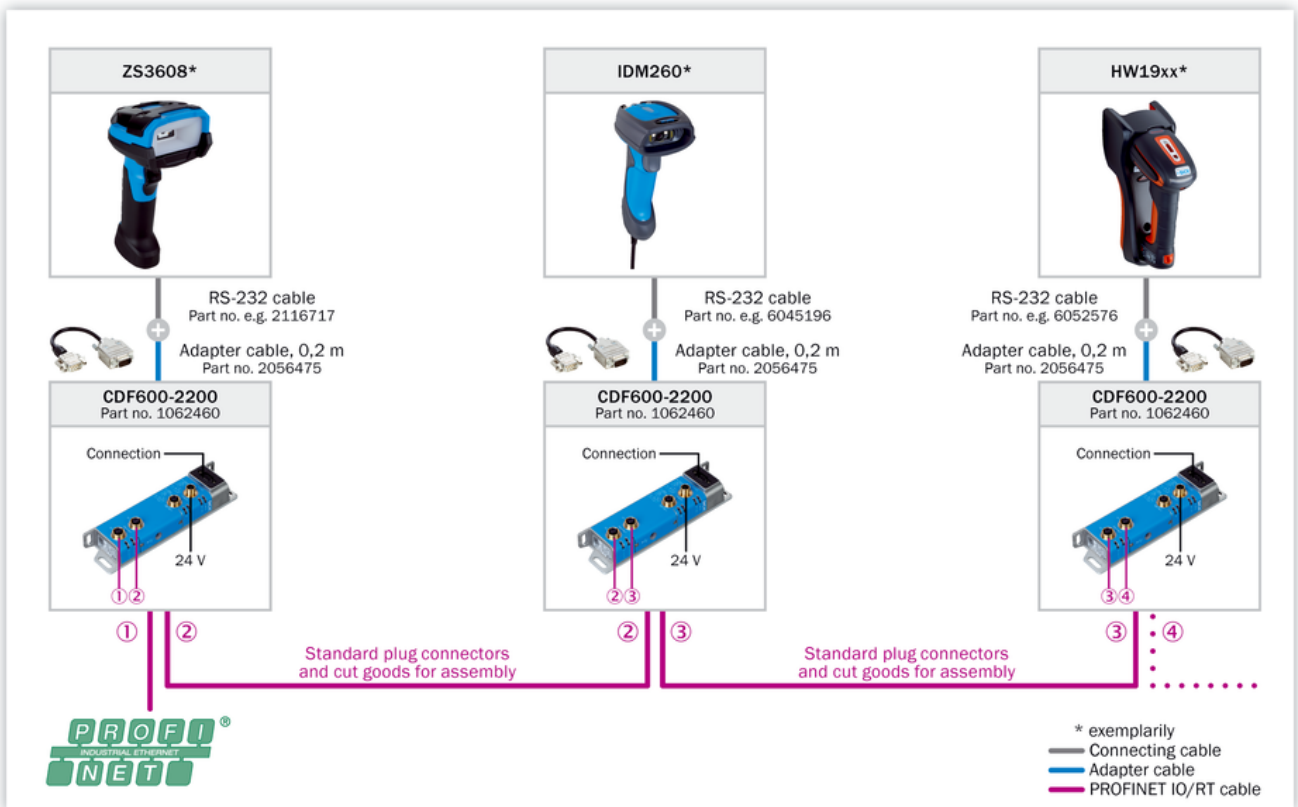

PROFIBUS DP

PROFIBUS DP

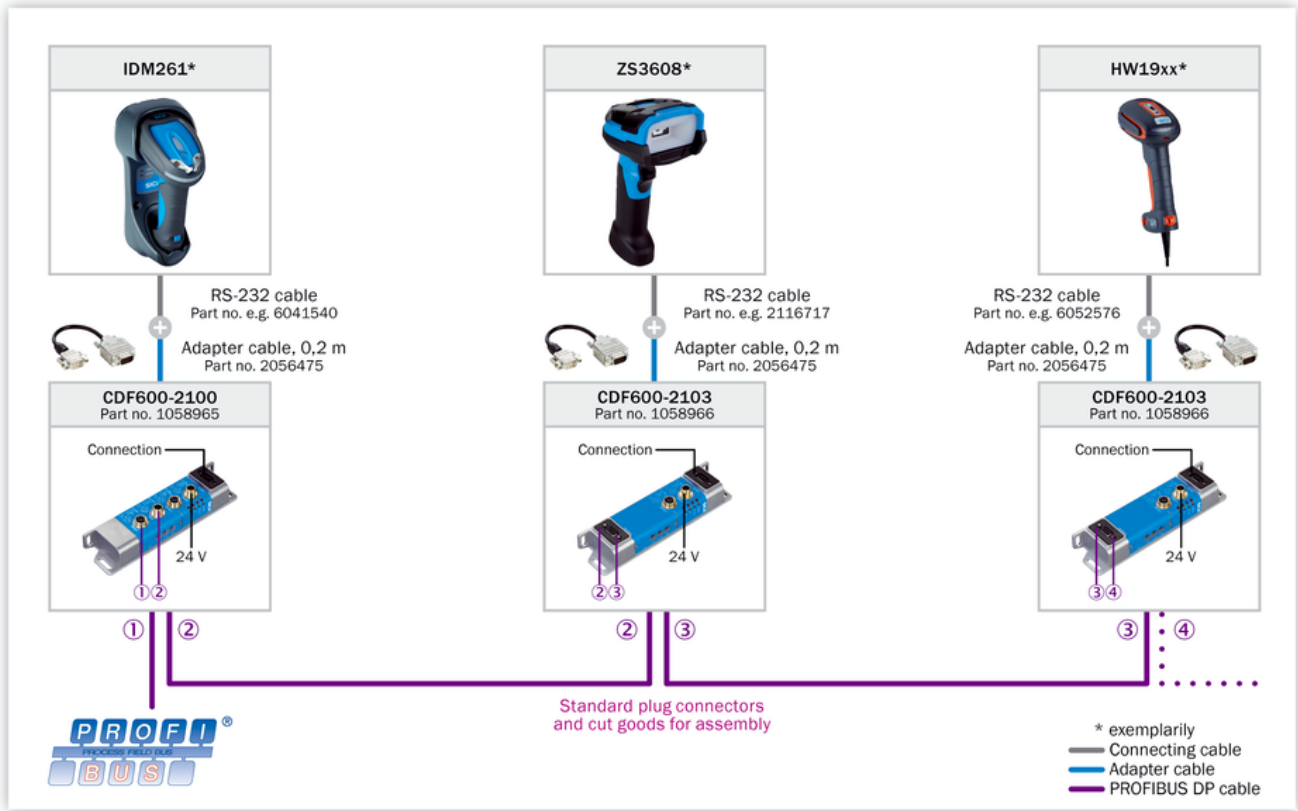

Ethernet TCP/IP

Ethernet TCP/IP

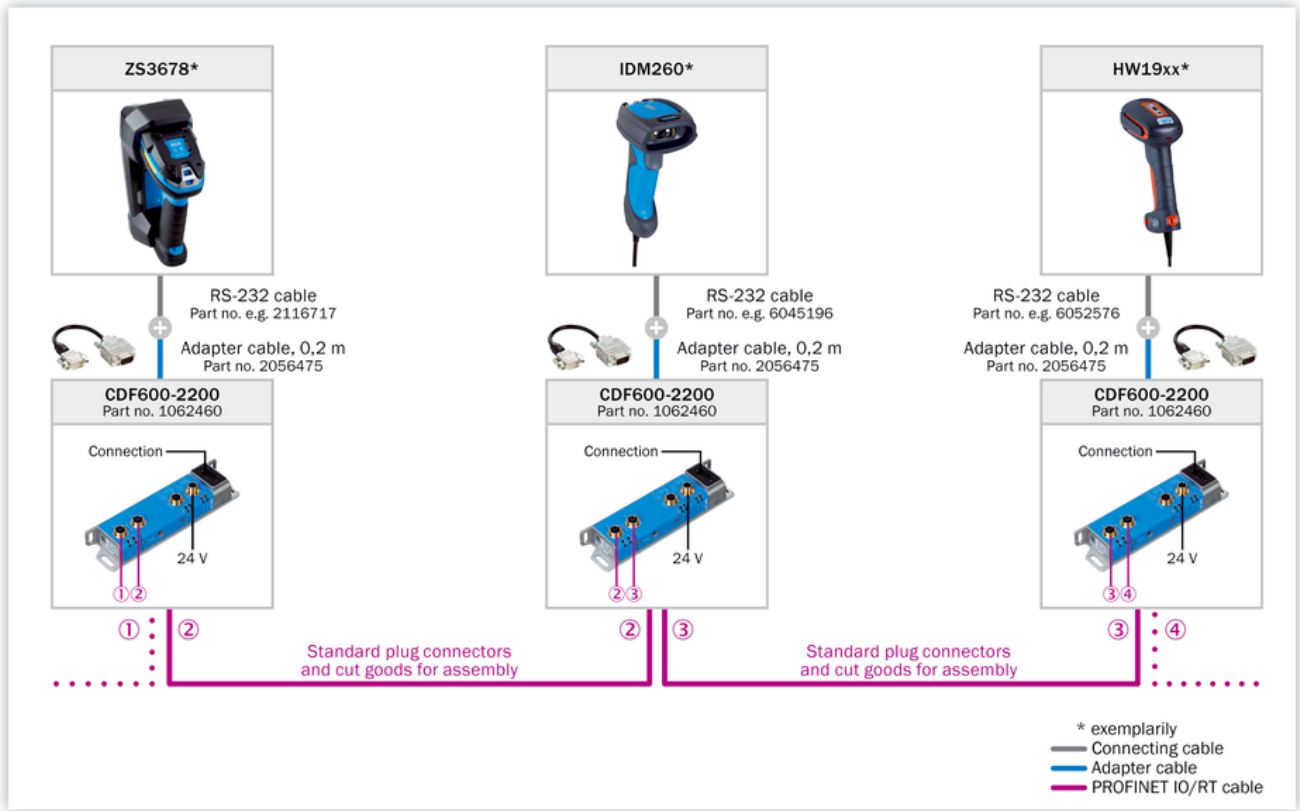

EtherCAT®

EtherCAT®

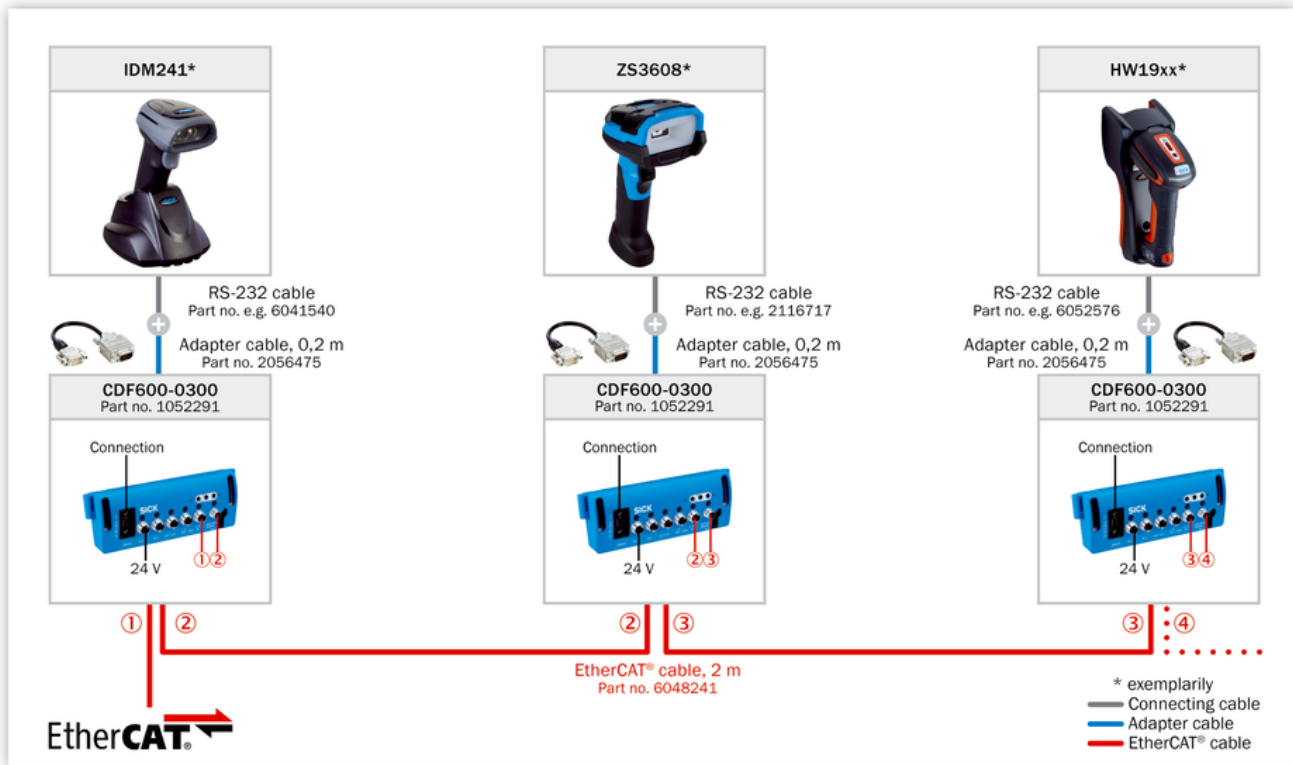

AUX looping

Looping-in via AUX

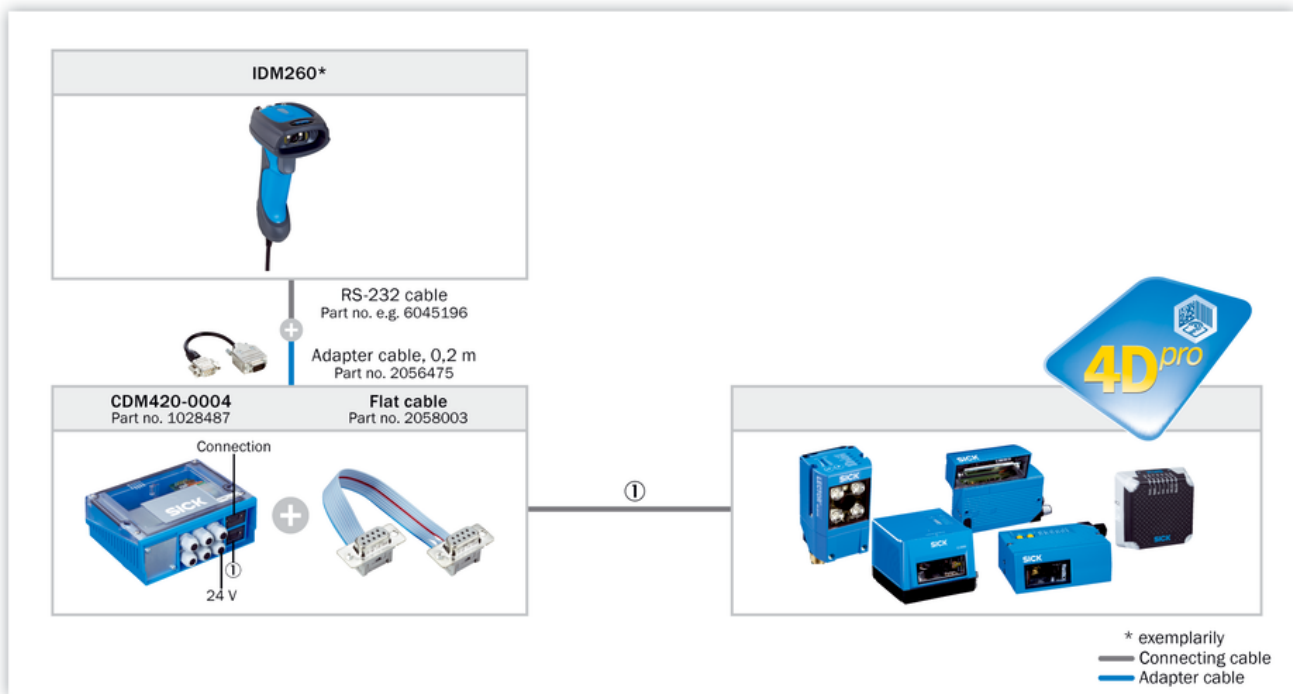

Selection Guide



*1) For EtherNet/IP third party gateway is required from e.g. Control or HMS (requires local sourcing).

Recommended accessories

Other models and accessories → www.sick.com/IDM

	Brief description	Type	Part no.
Fieldbus modules			
	Connection kit for connecting a hand-held scanner to a PROFINET (Siemens) interface	Hand-held scanner PROFINET kit	1101488
Other mounting accessories			
	Tripod mount	Stand mount	6045193
	Desk holder	Table mount	6045192
Rechargeable batteries and battery chargers			
	Wireless base station, supply voltage 5 V DC, current consumption max. 750 mA, interface: RS-232 True, USB	Base station	6068554

	Brief description	Type	Part no.
	Power supply, input AC 100 ... 240 V, output DC 5 V/2 A (necessary when using RS-232 TTL cable, does not fulfill medical standard EN 60601/ IEC 60601))	Power supply unit	6036722

Recommended services

Additional services → www.sick.com/IDM

	Type	Part no.
Extended warranty		
<ul style="list-style-type: none"> • Product area: Machine vision, LiDAR sensors, safety camera sensors, Safety laser scanners, Safety radar sensors, Radar sensors, Fixed mount barcode scanners, Image-based code readers, RFID, Mobile handheld scanners • Range of services: The services correspond to the scope of the statutory manufacturer warranty (SICK general terms of delivery). • Duration: Five-year warranty from delivery date. 	Extended warranty for a total of five years from delivery date	1680671

SICK AT A GLANCE

SICK is one of the leading manufacturers of intelligent sensors and sensor solutions for industrial applications. A unique range of products and services creates the perfect basis for controlling processes securely and efficiently, protecting individuals from accidents and preventing damage to the environment.

We have extensive experience in a wide range of industries and understand their processes and requirements. With intelligent sensors, we can deliver exactly what our customers need. In application centers in Europe, Asia and North America, system solutions are tested and optimized in accordance with customer specifications. All this makes us a reliable supplier and development partner.

Comprehensive services complete our offering: SICK LifeTime Services provide support throughout the machine life cycle and ensure safety and productivity.

For us, that is “Sensor Intelligence.”

WORLDWIDE PRESENCE:

Contacts and other locations –www.sick.com